

Safe with electronic combination

Programming the access code

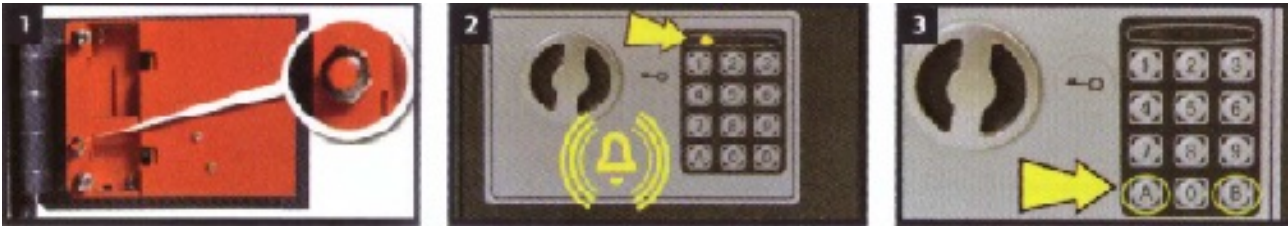

- Leave the safe door open during this procedure.
- Hold down the red button on the inside of the door (fig.1) until you have a double beep. A yellow light now lights up on the front. (fig.2)
- Now enter the desired number code. The length of the code must be a minimum of 3 and a maximum of 8 numbers.
- To save the code, press and hold the "A" or "B" button for about 15 seconds. (fig.3)
- A double beep and the yellow light going out confirm that the combination is saved.
- To check whether the code is correctly activated, enter the combination you just entered.
- Do this with a door still open.

Use of the safe

Proceed as follows to open and close the safe:



TO OPEN

- Enter your personal code followed by "A" or "B". A beep sounds and a green light appears light on. (fig.1)
- Turn the rotary knob clockwise within 5 seconds to open the door. (fig 2.)

CLOSE

- Close the door completely and turn the knob counterclockwise. See for yourself that the door is locked.

Attention!

In case that you enter an incorrect code three times in succession, you have to wait twenty minutes before making another attempt. Should you then again enter three times an incorrect cod, it is necessary to wait 5 minutes.